

BORDERTEC BBS-BCS

PRODUCT DESCRIPTION



This is a perimeter profile for the finishing and protection of the external tile border. It also has an upper edging trim designed to frame tiled surfaces where they are laid flush with the screed.

TECHNICAL FEATURES

Length: 2,70 meters

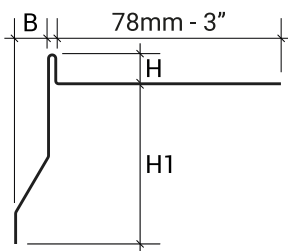

Stainless Steel BBS

H = 10 mm
B = 11.4 mm

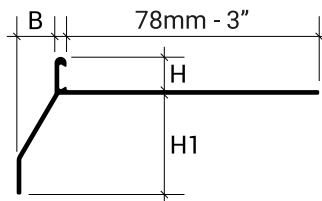

Aluminum BBS30

H = 10 mm
B = 11.4 mm

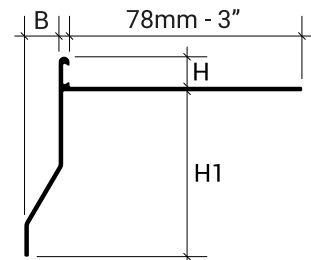

Aluminum BBS

H = 10 mm

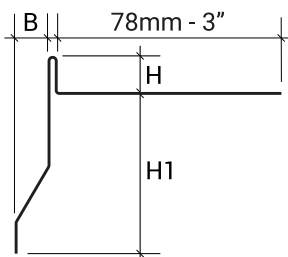

Stainless Steel BCS

H = 12,5 mm
B = 11.4 mm

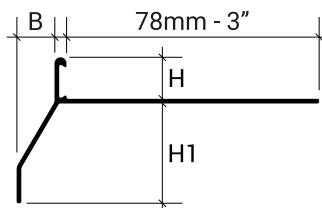

Aluminum BCS30

H = 12,5 mm
B = 11.4 mm

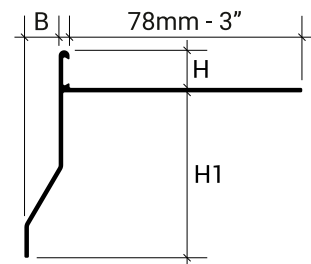

Aluminum BCS

H = 12,5 mm

ACCESSORIES



BBSI 42



BBSG



BBSE A22

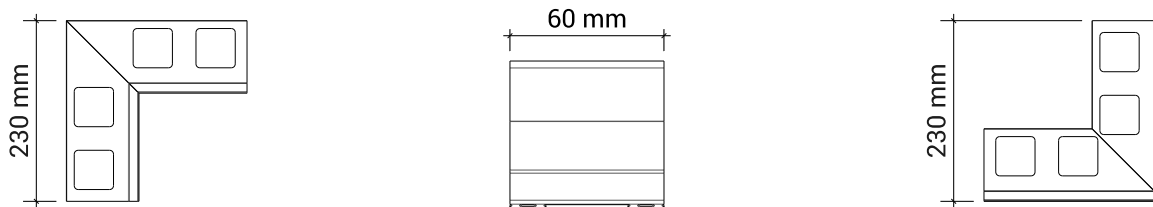

MATERIAL DESCRIPTION

Stainless Steel

Steel profiles are made by cold forming sheets of constant thickness, thus differing from the corresponding aluminum and brass versions made by hot extrusion, while maintaining their application and dimensional characteristics. Stainless steel effectively resists high mechanical stress and is particularly suitable for use in the chemical, food, and hospital sectors, where hygiene, durability, and chemical resistance are essential. Normally produced with a semi-gloss finish, a brushed finish can also be achieved by partially removing material using rotating nylon and quartz fiber brushes. This process gives the surface a matte appearance without altering its characteristics.

AISI 304 STAINLESS STEEL - EN X 5 CrNi 18 10 - DIN 1.4301:

This steel belongs to the AUSTENITIC category and is the most widespread and commonly used alloy for products requiring high technical and performance characteristics. It is highly resistant to most chemical agents but may stain or darken superficially; a standard polishing product is sufficient to restore its original appearance.



IS

bordertec >> BBS in Stainless Steel AISI 304 - DIN 1.4301 Brushed		
Item	H1 mm	Finish
BBS42IS270	42	IS - Brushed
BBS55IS270	55	IS - Brushed
BBS75IS270	75	IS - Brushed
BBS95IS270	95	IS - Brushed

bordertec >> BBSE External corner in Stainless Steel AISI 304 - DIN 1.4301		
Item	H1 mm	Finish
BBSE42IS	42	IS - Brushed
BBSE55IS	55	IS - Brushed
BBSE75IS	75	IS - Brushed
BBSE95IS	95	IS - Brushed

bordertec >> BBSG Joint in Stainless Steel AISI 304 - DIN 1.4301		
Item	H1 mm	Finish
BBSG42IS	42	IS - Brushed
BBSG55IS	55	IS - Brushed
BBSG75IS	75	IS - Brushed
BBSG95IS	95	IS - Brushed

bordertec >> BCS in Stainless Steel AISI 304 - DIN 1.4301 Brushed		
Item	H1 mm	Finish
BCS42IS270	42	IS - Brushed
BCS55IS270	55	IS - Brushed
BCS75IS270	75	IS - Brushed
BCS95IS270	95	IS - Brushed

bordertec >> BCSE External corner in Stainless Steel AISI 304 - DIN 1.4301		
Item	H1 mm	Finish
BCSE42IS	42	IS - Brushed
BCSE55IS	55	IS - Brushed
BCSE75IS	75	IS - Brushed
BCSE95IS	95	IS - Brushed

bordertec >> BCSG Joint in Stainless Steel AISI 304 - DIN 1.4301		
Item	H1 mm	Finish
BCSG42IS	42	IS - Brushed
BCSG55IS	55	IS - Brushed
BCSG75IS	75	IS - Brushed
BCSG95IS	95	IS - Brushed

Profilitec S.p.A.
 Via Scotte, 3 - 36033 Isola Vicentina (Vicenza), ITALY
 Tel: +39 0444 268311
 e-mail: profilitec@profilitec.com

Profilitec Corp.
 e-mail: customerservice@profilitec.com

Profilitec France
 e-mail: france@profilitec.com

Profilitec Ibérica, S.L.U.
 e-mail: iberica@profilitec.com

MATERIAL DESCRIPTION

Aluminum

The primary aluminum alloy EN AW-6060 in T6 temper is suitable for complex extrusions, offering high strength and an excellent natural surface finish that lends itself well to subsequent finishing processes.

ANODIZED ALUMINUM:

The anodic oxidation process provides protection against corrosion caused by atmospheric agents, without involving galvanic treatments.

In accordance with the EN 12373 standard, profiles undergo preliminary treatments that create a uniformly matte surface. They are then colored through an electrochemical oxidation process in standard finishes: Silver, Gold, Bronze, Copper, and Titanium, with a coating thickness of up to 20 microns.

POWDER COATED ALUMINUM:

Powder coating begins with a chromium phosphate pre-treatment, followed by electrostatic application of polyester powders that offer high resistance to U.V. rays and atmospheric agents. The entire surface of the profile is coated with an average thickness of approximately 60 microns. A hot cross-linking polymerization process is then carried out to ensure maximum chemical and mechanical resistance.



bordertec >> BBS in Anodized Aluminum		
Item	H1 mm	Finish
BBS30AS270	30	AS - Silver

bordertec >> BBSE Corner Outside Anodized Aluminum		
Item	H1 mm	Finish
BBSE30AS	30	AS - Silver

bordertec >> BBSG Anodized Aluminum Joint		
Item	H1 mm	Finish
BBSG30AS	30	AS - Silver

bordertec >> BCS in Anodized Aluminum		
Item	H1 mm	Finish
BCS30AS270	30	AS - Silver

bordertec >> BCSE Corner Outside Anodized Aluminum		
Item	H1 mm	Finish
BCSE30AS	30	AS - Silver

bordertec >> BCSG Anodized Aluminum Joint		
Item	H1 mm	Finish
BCSG30AS	30	AS - Silver

bordertec >> BBS in Powder Coated Aluminum		
Item	H1 mm	Finish
BBS30A11270	30	A11 - Pure White
BBS42A11270	42	A11 - Pure White
BBS55A11270	55	A11 - Pure White
BBS75A11270	75	A11 - Pure White
BBS95A11270	95	A11 - Pure White
BBS30A22270	30	A22 - Pastel Grey
BBS42A22270	42	A22 - Pastel Grey
BBS55A22270	55	A22 - Pastel Grey
BBS75A22270	75	A22 - Pastel Grey
BBS95A22270	95	A22 - Pastel Grey

bordertec >> BBSE External corner in Powder Coated Aluminum		
Item	H1 mm	Finish
BBSE30A11	30	A11 - Pure White
BBSE42A11	42	A11 - Pure White
BBSE55A11	55	A11 - Pure White
BBSE75A11	75	A11 - Pure White
BBSE95A11	95	A11 - Pure White
BBSE30A22	30	A22 - Pastel Grey
BBSE42A22	42	A22 - Pastel Grey
BBSE55A22	55	A22 - Pastel Grey
BBSE75A22	75	A22 - Pastel Grey
BBSE95A22	95	A22 - Pastel Grey

Profilitec S.p.A.
Via Scotte, 3 - 36033 Isola Vicentina (Vicenza), ITALY
Tel: +39 0444 268311
e-mail: profilitec@profilitec.com

Profilitec Corp.
e-mail: customerservice@profilitec.com

Profilitec France
e-mail: france@profilitec.com

Profilitec Ibérica, S.L.U.
e-mail: iberica@profilitec.com

bordertec >> BBSG Joint in Powder Coated Aluminum		
Item	H1 mm	Finish
BBSG30A11	30	A11 - Pure White
BBSG42A11	42	A11 - Pure White
BBSG55A11	55	A11 - Pure White
BBSG75A11	75	A11 - Pure White
BBSG95A11	95	A11 - Pure White
BBSG30A22	30	A22 - Pastel Grey
BBSG42A22	42	A22 - Pastel Grey
BBSG55A22	55	A22 - Pastel Grey
BBSG75A22	75	A22 - Pastel Grey
BBSG95A22	95	A22 - Pastel Grey

bordertec >> BBSI Internal corner in Powder Coated Aluminum		
Item	H1 mm	Finish
BBSI42A11	42	A11 - Pure White
BBSI55A11	55	A11 - Pure White
BBSI42A22	42	A22 - Pastel Grey
BBSI55A22	55	A22 - Pastel Grey

bordertec >> BBSGT Joint in Powder Coated Aluminum		
Item	H1 mm	Finish
BBSGT42A22	42	A22 - Pastel Grey

bordertec >> BCS in Powder Coated Aluminum		
Item	H1 mm	Finish
BCS30A11270	30	A11 - Pure White
BCS42A11270	42	A11 - Pure White
BCS55A11270	55	A11 - Pure White
BCS75A11270	75	A11 - Pure White
BCS95A11270	95	A11 - Pure White
BCS30A22270	30	A22 - Pastel Grey
BCS42A22270	42	A22 - Pastel Grey
BCS55A22270	55	A22 - Pastel Grey
BCS75A22270	75	A22 - Pastel Grey
BCS95A22270	95	A22 - Pastel Grey

bordertec >> BCSE External corner in Powder Coated Aluminum		
Item	H1 mm	Finish
BCSE30A11	30	A11 - Pure White
BCSE42A11	42	A11 - Pure White
BCSE55A11	55	A11 - Pure White
BCSE75A11	75	A11 - Pure White
BCSE95A11	95	A11 - Pure White
BCSE30A22	30	A22 - Pastel Grey
BCSE42A22	42	A22 - Pastel Grey
BCSE55A22	55	A22 - Pastel Grey
BCSE75A22	75	A22 - Pastel Grey
BCSE95A22	95	A22 - Pastel Grey

bordertec >> BCSG Joint in Powder Coated Aluminum		
Item	H1 mm	Finish
BCSG30A11	30	A11 - Pure White
BCSG42A11	42	A11 - Pure White
BCSG55A11	55	A11 - Pure White
BCSG75A11	75	A11 - Pure White
BCSG95A11	95	A11 - Pure White
BCSG30A22	30	A22 - Pastel Grey
BCSG42A22	42	A22 - Pastel Grey
BCSG55A22	55	A22 - Pastel Grey
BCSG75A22	75	A22 - Pastel Grey
BCSG95A22	95	A22 - Pastel Grey

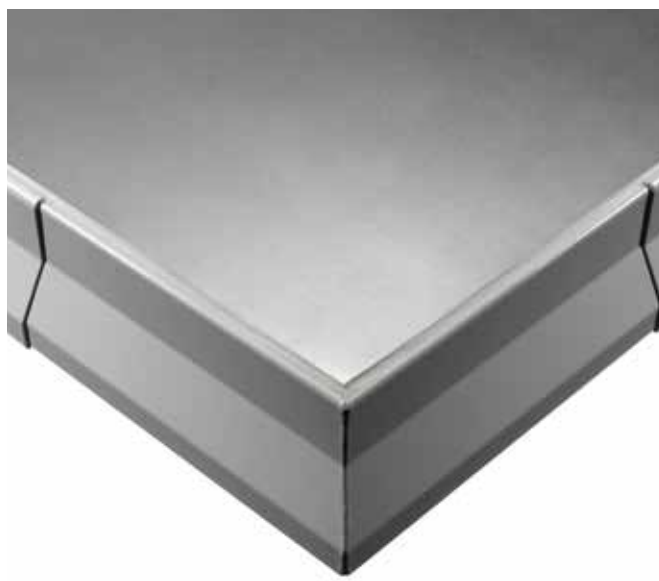
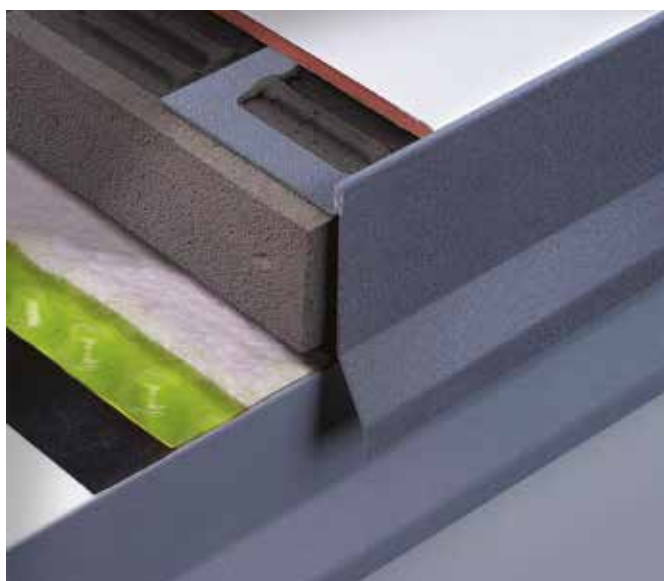

Profilitec S.p.A.
 Via Scotte, 3 - 36033 Isola Vicentina (Vicenza), ITALY
 Tel: +39 0444 268311
 e-mail: profilitec@profilitec.com

Profilitec Corp.
 e-mail: customerservice@profilitec.com

Profilitec France
 e-mail: france@profilitec.com

Profilitec Ibérica, S.L.U.
 e-mail: iberica@profilitec.com

bordertec >> BBS in Embossed Powder Coated Aluminum		
Item	H1 mm	Finish
BBS30A14270	30	A14 - White Arctic
BBS42A14270	42	A14 - White arctic
BBS55A14270	55	A14 - White arctic
BBS75A14270	75	A14 - White arctic
BBS95A14270	95	A14 - White arctic
BBS30A24270	30	A24 - Embossed Pastel Grey
BBS42A24270	42	A24 - Embossed pastel grey
BBS55A24270	55	A24 - Embossed pastel grey
BBS75A24270	75	A24 - Embossed pastel grey
BBS95A24270	95	A24 - Embossed pastel grey
BBS30A25270	30	A25 - Embossed Cement Grey
BBS42A25270	42	A25 - Embossed Cement Grey
BBS55A25270	55	A25 - Embossed Cement Grey
BBS75A25270	75	A25 - Embossed Cement Grey
BBS95A25270	95	A25 - Embossed Cement Grey
BBS30A50270	30	A50 - Embos. Micaceous Grey
BBS42A50270	42	A50 - Embossed Micaceous
BBS55A50270	55	A50 - Embossed Micaceous
BBS75A50270	75	A50 - Embossed Micaceous
BBS95A50270	95	A50 - Embossed Micaceous
BBS30A60270	30	A60 - Embossed Corten
BBS42A60270	42	A60 - Embossed Corten
BBS55A60270	55	A60 - Embossed Corten
BBS75A60270	75	A60 - Embossed Corten
BBS95A60270	95	A60 - Embossed Corten
BBS30A63270	30	A63 - Dark Brown
BBS42A63270	42	A63 - Dark Brown
BBS55A63270	55	A63 - Dark Brown
BBS75A63270	75	A63 - Dark Brown
BBS95A63270	95	A63 - Dark Brown
BBS30A64270	30	A64 - Embossed Dark Brown
BBS42A64270	42	A64 - Embossed Dark Brown
BBS55A64270	55	A64 - Embossed Dark Brown
BBS75A64270	75	A64 - Embossed Dark Brown
BBS95A64270	95	A64 - Embossed Dark Brown

bordertec >> BBSI Internal Corner in Embossed Powder Coated Aluminum		
Item	H1 mm	Finish
BBSI42A50	42	A50 - Embossed Micaceous
BBSI55A50	55	A50 - Embossed Micaceous

bordertec >> BBSE External corner in Embossed Powder Coated Aluminum		
Item	H1 mm	Finish
BBSE30A14	30	A14 - White Arctic
BBSE42A14	42	A14 - White arctic
BBSE55A14	55	A14 - White arctic
BBSE75A14	75	A14 - White arctic
BBSE95A14	95	A14 - White arctic
BBSE30A24	30	A24 - Embossed Pastel Grey
BBSE42A24	42	A24 - Embossed pastel grey
BBSE55A24	55	A24 - Embossed pastel grey
BBSE75A24	75	A24 - Embossed pastel grey
BBSE95A24	95	A24 - Embossed pastel grey
BBSE30A25	30	A25 - Embossed Cement Grey
BBSE42A25	42	A25 - Embossed Cement Grey
BBSE55A25	55	A25 - Embossed Cement Grey
BBSE75A25	75	A25 - Embossed Cement Grey
BBSE95A25	95	A25 - Embossed Cement Grey
BBSE30A50	30	A50 - Embos. Micaceous Grey
BBSE42A50	42	A50 - Embossed Micaceous
BBSE55A50	55	A50 - Embossed Micaceous
BBSE75A50	75	A50 - Embossed Micaceous
BBSE95A50	95	A50 - Embossed Micaceous
BBSE30A60	30	A60 - Embossed Corten
BBSE42A60	42	A60 - Embossed Corten
BBSE55A60	55	A60 - Embossed Corten
BBSE75A60	75	A60 - Embossed Corten
BBSE95A60	95	A60 - Embossed Corten
BBSE30A63	30	A63 - Dark Brown
BBSE42A63	42	A63 - Dark Brown
BBSE55A63	55	A63 - Dark Brown
BBSE75A63	75	A63 - Dark Brown
BBSE95A63	95	A63 - Dark Brown
BBSE30A64	30	A64 - Embossed Dark Brown
BBSE42A64	42	A64 - Embossed Dark Brown
BBSE55A64	55	A64 - Embossed Dark Brown
BBSE75A64	75	A64 - Embossed Dark Brown
BBSE95A64	95	A64 - Embossed Dark Brown

bordertec >> BBSG Joint in Embossed Powder Coated Aluminum		
Item	H1 mm	Finish
BBSG30A14	30	A14 - White Arctic
BBSG42A14	42	A14 - White arctic
BBSG55A14	55	A14 - White arctic
BBSG75A14	75	A14 - White arctic
BBSG95A14	95	A14 - White arctic
BBSG30A24	30	A24 - Embossed Pastel Grey
BBSG42A24	42	A24 - Embossed pastel grey
BBSG55A24	55	A24 - Embossed pastel grey
BBSG75A24	75	A24 - Embossed pastel grey
BBSG95A24	95	A24 - Embossed pastel grey
BBSG30A25	30	A25 - Embossed Cement Grey
BBSG42A25	42	A25 - Embossed Cement Grey
BBSG55A25	55	A25 - Embossed Cement Grey
BBSG75A25	75	A25 - Embossed Cement Grey
BBSG95A25	95	A25 - Embossed Cement Grey
BBSG30A50	30	A50 - Embos. Micaceous Grey
BBSG42A50	42	A50 - Embossed Micaceous
BBSG55A50	55	A50 - Embossed Micaceous
BBSG75A50	75	A50 - Embossed Micaceous
BBSG95A50	95	A50 - Embossed Micaceous

Profilitec S.p.A.
 Via Scotte, 3 - 36033 Isola Vicentina (Vicenza), ITALY
 Tel: +39 0444 268311
 e-mail: profilitec@profilitec.com

Profilitec Corp.
 e-mail: customerservice@profilitec.com

Profilitec Ibérica, S.L.U.
 e-mail: iberica@profilitec.com

Profilitec France
 e-mail: france@profilitec.com

BBSG30A60	30	A60 - Embossed Corten
BBSG42A60	42	A60 - Embossed Corten
BBSG55A60	55	A60 - Embossed Corten
BBSG75A60	75	A60 - Embossed Corten
BBSG95A60	95	A60 - Embossed Corten
BBSG30A63	30	A63 - Dark Brown
BBSG42A63	42	A63 - Dark Brown
BBSG55A63	55	A63 - Dark Brown
BBSG75A63	75	A63 - Dark Brown
BBSG95A63	95	A63 - Dark Brown
BBSG30A64	30	A64 - Embossed Dark Brown
BBSG42A64	42	A64 - Embossed Dark Brown
BBSG55A64	55	A64 - Embossed Dark Brown
BBSG75A64	75	A64 - Embossed Dark Brown
BBSG95A64	95	A64 - Embossed Dark Brown

bordertec >> BCS in Embossed Powder Coated Aluminum

Item	H1 mm	Finish
BCS30A14270	30	A14 - White Arctic
BCS42A14270	42	A14 - White arctic
BCS55A14270	55	A14 - White arctic
BCS75A14270	75	A14 - White arctic
BCS95A14270	95	A14 - White arctic
BCS30A24270	30	A24 - Embossed Pastel Grey
BCS42A24270	42	A24 - Embossed pastel grey
BCS55A24270	55	A24 - Embossed pastel grey
BCS75A24270	75	A24 - Embossed pastel grey
BCS95A24270	95	A24 - Embossed pastel grey
BCS30A25270	30	A25 - Embossed Cement Grey
BCS42A25270	42	A25 - Embossed Cement Grey
BCS55A25270	55	A25 - Embossed Cement Grey
BCS75A25270	75	A25 - Embossed Cement Grey
BCS95A25270	95	A25 - Embossed Cement Grey
BCS30A50270	30	A50 - Embos. Micaceous Grey
BCS42A50270	42	A50 - Embossed Micaceous
BCS55A50270	55	A50 - Embossed Micaceous
BCS75A50270	75	A50 - Embossed Micaceous
BCS95A50270	95	A50 - Embossed Micaceous
BCS30A60270	30	A60 - Embossed Corten
BCS42A60270	42	A60 - Embossed Corten
BCS55A60270	55	A60 - Embossed Corten
BCS75A60270	75	A60 - Embossed Corten
BCS95A60270	95	A60 - Embossed Corten
BCS30A63270	30	A63 - Dark Brown
BCS42A63270	42	A63 - Dark Brown
BCS55A63270	55	A63 - Dark Brown
BCS75A63270	75	A63 - Dark Brown
BCS95A63270	95	A63 - Dark Brown
BCS30A64270	30	A64 - Embossed Dark Brown
BCS42A64270	42	A64 - Embossed Dark Brown
BCS55A64270	55	A64 - Embossed Dark Brown
BCS75A64270	75	A64 - Embossed Dark Brown
BCS95A64270	95	A64 - Embossed Dark Brown

bordertec >> BCSE External corner in Embossed Powder Coated Aluminum

Item	H1 mm	Finish
BCSE30A14	30	A14 - White Arctic
BCSE42A14	42	A14 - White arctic
BCSE55A14	55	A14 - White arctic
BCSE75A14	75	A14 - White arctic
BCSE95A14	95	A14 - White arctic
BCSE30A24	30	A24 - Embossed Pastel Grey
BCSE42A24	42	A24 - Embossed pastel grey
BCSE55A24	55	A24 - Embossed pastel grey
BCSE75A24	75	A24 - Embossed pastel grey
BCSE95A24	95	A24 - Embossed pastel grey
BCSE30A25	30	A25 - Embossed Cement Grey
BCSE42A25	42	A25 - Embossed Cement Grey
BCSE55A25	55	A25 - Embossed Cement Grey
BCSE75A25	75	A25 - Embossed Cement Grey
BCSE95A25	95	A25 - Embossed Cement Grey
BCSE30A50	30	A50 - Embos. Micaceous Grey
BCSE42A50	42	A50 - Embossed Micaceous
BCSE55A50	55	A50 - Embossed Micaceous
BCSE75A50	75	A50 - Embossed Micaceous
BCSE95A50	95	A50 - Embossed Micaceous
BCSE30A60	30	A60 - Embossed Corten
BCSE42A60	42	A60 - Embossed Corten
BCSE55A60	55	A60 - Embossed Corten
BCSE75A60	75	A60 - Embossed Corten
BCSE95A60	95	A60 - Embossed Corten
BCSE30A63	30	A63 - Dark Brown
BCSE42A63	42	A63 - Dark Brown
BCSE55A63	55	A63 - Dark Brown
BCSE75A63	75	A63 - Dark Brown
BCSE95A63	95	A63 - Dark Brown
BCSE30A64	30	A64 - Embossed Dark Brown
BCSE42A64	42	A64 - Embossed Dark Brown
BCSE55A64	55	A64 - Embossed Dark Brown
BCSE75A64	75	A64 - Embossed Dark Brown
BCSE95A64	95	A64 - Embossed Dark Brown

Profilitec S.p.A.
 Via Scotte, 3 - 36033 Isola Vicentina (Vicenza), ITALY
 Tel: +39 0444 268311
 e-mail: profilitec@profilitec.com

Profilitec Corp.
 e-mail: customerservice@profilitec.com

Profilitec France
 e-mail: france@profilitec.com

Profilitec Ibérica, S.L.U.
 e-mail: iberica@profilitec.com

bordertec >> BCSG Joint in Embossed Powder Coated Aluminum		
Item	H1 mm	Finish
BCSG30A14	30	A14 - White Arctic
BCSG42A14	42	A14 - White arctic
BCSG55A14	55	A14 - White arctic
BCSG75A14	75	A14 - White arctic
BCSG95A14	95	A14 - White arctic
BCSG30A24	30	A24 - Embossed Pastel Grey
BCSG42A24	42	A24 - Embossed pastel grey
BCSG55A24	55	A24 - Embossed pastel grey
BCSG75A24	75	A24 - Embossed pastel grey
BCSG95A24	95	A24 - Embossed pastel grey
BCSG30A25	30	A25 - Embossed Cement Grey
BCSG42A25	42	A25 - Embossed Cement Grey
BCSG55A25	55	A25 - Embossed Cement Grey
BCSG75A25	75	A25 - Embossed Cement Grey
BCSG95A25	95	A25 - Embossed Cement Grey
BCSG30A50	30	A50 - Embos. Micaceous Grey
BCSG42A50	42	A50 - Embossed Micaceous
BCSG55A50	55	A50 - Embossed Micaceous
BCSG75A50	75	A50 - Embossed Micaceous
BCSG95A50	95	A50 - Embossed Micaceous
BCSG30A60	30	A60 - Embossed Corten
BCSG42A60	42	A60 - Embossed Corten
BCSG55A60	55	A60 - Embossed Corten
BCSG75A60	75	A60 - Embossed Corten
BCSG95A60	95	A60 - Embossed Corten
BCSG30A63	30	A63 - Dark Brown
BCSG42A63	42	A63 - Dark Brown
BCSG55A63	55	A63 - Dark Brown
BCSG75A63	75	A63 - Dark Brown
BCSG95A63	95	A63 - Dark Brown
BCSG30A64	30	A64 - Embossed Dark Brown
BCSG42A64	42	A64 - Embossed Dark Brown
BCSG55A64	55	A64 - Embossed Dark Brown
BCSG75A64	75	A64 - Embossed Dark Brown
BCSG95A64	95	A64 - Embossed Dark Brown

APPLICATION

1. Choose the H-size profile corresponding to the thickness of the covering to be laid, taking care to ensure that the profile does not exceed the edge of the covering but is positioned 0,5 to 1 mm lower;
2. Cut to the desired length;
3. Fix the profiles to the screed with nails, taking care to separate them by at least 1 cm from the screed and taking care to leave at least 0.5 cm of space between adjacent profiles and mask that space with the joint;
4. Spread the adhesive in the profile application area with the help of a notched trowel;
5. Apply the desired waterproofing system (Balcotec System) where applicable;
6. Lay the flooring, taking care to leave a gap of about 5 mm between tile and profile.

N.B.: Aluminum profiles offer limited resistance to alkaline substances, so their use must be evaluated according to the expected chemical aggressions. Aluminum profiles in contact with cementitious substances can be attacked by corrosion processes, so residues of used adhesives and sealants should be removed immediately. When laying, the right amount of adhesive must be used and the right drying times observed, avoiding creating cavities in which water can stagnate, which would lead to the formation of alkaline substances (aluminum hydroxide) and trigger corrosive electrolytic phenomena.

Profilitec S.p.A.
 Via Scotte, 3 - 36033 Isola Vicentina (Vicenza), ITALY
 Tel: +39 0444 268311
 e-mail: profilitec@profilitec.com

Profilitec Corp.
 e-mail: customerservice@profilitec.com

Profilitec France
 e-mail: france@profilitec.com

Profilitec Ibérica, S.L.U.
 e-mail: iberica@profilitec.com

CLEANING AND MAINTENANCE

STAINLESS STEEL:

Stainless steel is easy to clean and very hygienic because of its smooth, nonporous surface, which hinders the growth of bacteria. To keep it in good condition, simply wash it with warm soapy water, rinse it thoroughly and dry it with a soft cloth. If exposed to weathering, periodic cleaning is recommended to prevent corrosion. Brushed surfaces should be cleaned in the direction of brushing. In case of scratches, a specific polish can be used with a soft cloth.

Avoid cleaning agents containing hydrochloric acid, hydrofluoric acid or bleach, as well as abrasive products. Do not leave ordinary steel objects in contact with stainless steel to prevent contamination and rust stains. Also, do not leave damp patches or sponges on the surface to prevent water halos.

ALUMINIUM:

Aluminum requires no special maintenance.

For cleaning, use colorless alcohol diluted in water or neutral detergents, avoiding acidic ones (e.g., hydrochloric or hydrofluoric acid); use non-abrasive sponges or cloths to avoid damage. We recommend not applying cleaners directly to surfaces. After cleaning, rinse with water and dry immediately with a soft cloth. Avoid polishes. Quickly remove residual cement or grout to protect the surface.

WARNINGS

These profiles should be handled with care, using cut-resistant gloves. The indications and prescriptions herein, while corresponding to our experience, are to be considered purely indicative and must be confirmed by exhaustive practical applications. Profilitec declines any responsibility for any damage to people or things resulting from improper use of the products. The user is required to determine whether or not the product is suitable for use and assumes all responsibility arising from incorrect installation of the material.

BILL OF QUANTITIES ITEM

Supply and installation of profile in _____ (material), with _____
 _____ finish (refer to the Material Description section) in the characteristic size _____ mm,
 equipped with a punched flange that guarantees a perfect grip with the adhesive used. Profile with dovetail inner part for
 better adhesive grip.

Family type _____ from the Profilitec company as a painted aluminium perimeter profile suitable
 for laying terrace and balcony flooring, to be supplied and installed properly, following the methods and fields of application
 suggested by the manufacturer.

Profile length: 2700 mm

Profile SKU: _____

Material: _____ €/m

Installation: _____ €/m

Totale price: _____ €/m