

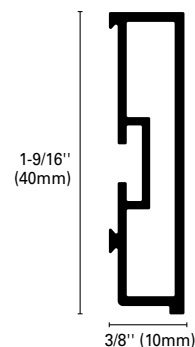

BA 400 A* minimalist baseboard discretely blends as an interior design element.

- Sharp angles;
- Rectangular cross-section;
- Only 1-9/16" (40mm) high

The profile is equipped with an inner cavity which maximizes adhesive grip. Internal / external joints and endcaps complete the installation with minimal visual impact.



skirting BA

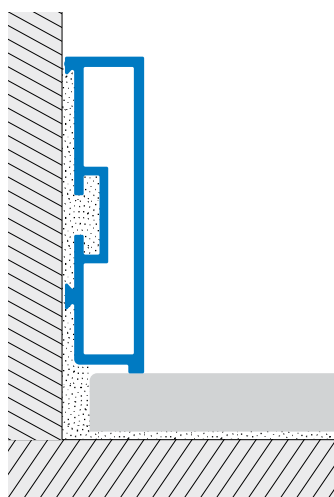



SKIRTING BA 400 ASN Silver Anodized Aluminum

This extruded profile has a silver coating over its visible surface which offers adequate resistance to corrosion. A single finishing element acts as an endcap, internal and external corner joint.

	H = in	mm	Art.		
Material: Extruded Anodized Aluminum	1-9/16	40	BA	400	ASN
Finish: Silver (AS)					
Length: 8'10" (2.70meters)					
Height: 1-9/16" (40mm)					
End cap:	1-9/16	40	BAC	400	AS

SKIRTING BA 400 ASS Brushed Silver Anodized Aluminum

This extruded profile is brushed and silver anodized, combining aesthetic impact with corrosion resistance. A single finishing element acts as an endcap, internal and external corner joint.

Material: Extruded Anodized Aluminum	1-9/16	40	BA	400	ASS
Finish: Silver brushed (ASS)					
Length: 8'10" (2.70meters)					
Height: 1-9/16" (40mm)					
End cap:	1-9/16	40	BAC	400	ASS

SKIRTING BA 400 ASB Chrome Anodized Aluminum

This extruded profile has a polished surface resistant to corrosion and especially suited for matching bathroom accessories. A single finishing element acts as an endcap, internal and external corner joint.

Material: Extruded Anodized Aluminum	1-9/16	40	BA	400	ASB
Finish: Silver Polished Chrome (ASB)					
Length: 8'10" (2.70meters)					
Height: 1-9/16" (40mm)					
End cap:	1-9/16	40	BAC	400	ASB

SKIRTING BA 400 A* Powder-Coated Aluminum in Corten Brown, Sandblasted Gray, Matte White

This aluminum profile is color-coated with a polyester powder coat. A single finishing element acts as an endcap, internal and external corner joint.

Material: Powder Coated Aluminum	1-9/16	40	BA	400	A60/A50/AM11
Finish: Corten (A60), Micaceous grey (A50), Mat white (AM11)					
Length: 8'10" (2.70meters)					
Height: 1-9/16" (40mm)					
End cap:	1-9/16	40	BAC	400	A60/A50/AM11