

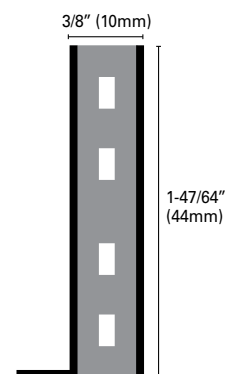

COFLEX CTM expansion joints are composed of a metal structure and a flexible yet durable central infill that can be ground and polished on-site. Due to their resistance to corrosion and wear, the profiles are ideal for resin-based terrazzo and natural stone tile installations. Ideally used in retail shops, hotels, sports facilities and schools. Suggested floor bays: 172-7/32"ft² (16m²).



coflex CTM

N.B.: in the photo the joint CTM lateral wing has been removed.

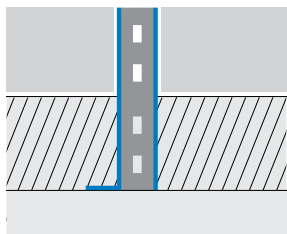

COFLEX CTM-ON* Brass + Grindable Infill (EPDM)

This profile guarantees high resistance to chemical and mechanical stress and wear. Suitable for indoor and outdoor areas with elegant, classic detailing.



| | H = in | mm | Color | Art. | | |
|---|---------|----|----------|------|-----|-------------|
| Material: Brass | 1/47/64 | 44 | Black 51 | CTM | 440 | ON 51/23/32 |
| Finish: Natural (ON) | | | | | | |
| Insert: EPDM Black (P51), Cement grey (P23), Beige (P32) | | | | | | |
| Length: 8'10" (2.70meters) | | | | | | |

COFLEX CTM-IL* Polished Stainless Steel AISI 304 – DIN 1.4301 + Grindable Infill (EPDM)

This cold-rolled stainless steel profile is ideal for food processing plants, commercial kitchens, and hospitals. Suitable for indoor and outdoor applications with excellent resistance to corrosion and good mechanical resistance.



| | | | | | | |
|---|---------|----|----------|-----|-----|-------------|
| Material: Stainless steel AISI 304 | 1/47/64 | 44 | Black 51 | CTM | 440 | IL 51/23/32 |
| Finish: Polished (IL) | | | | | | |
| Insert: EPDM Black (P51), Cement grey (P23), Beige (P32) | | | | | | |
| Length: 8'10" (2.70meters) | | | | | | |