

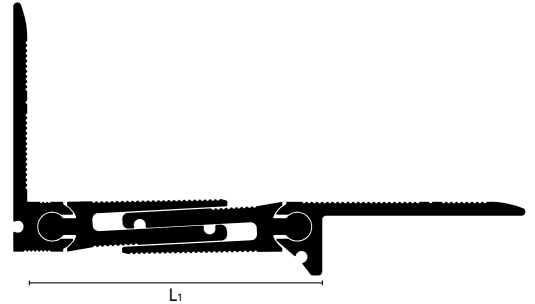

jointec GADP

JOINTEC GADP aluminum sliding expansion joints are wall and floor profiles structurally designed to bear loads of large scale buildings or building compounds. They can be installed in the interstitial space between two sections of a building or between two bays. This technical joint links these interspaces, moving three-dimensionally to accommodate a building's structural and material settlement. The structural bays defined by this profile should be further subdivided with smaller scale movement / expansion joints, chosen according to the expected use and flooring type. The vertical anchoring flange of the profile can be installed on the wall facing upwards or downwards hidden in the gap between the wall and the floor. For further information, see page 263.



(GADP 700 AN)

INSTALLATION:

- Anchor the side plates with:
 - appropriate screws, 7-3/32" (18cm) on center, on both sides of the profile and
 - two-part epoxy adhesive.

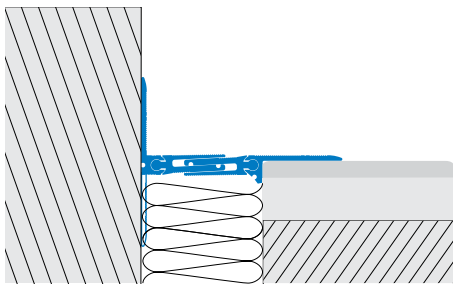

JOINTEC GADP* AN Natural Aluminum

Bridges a 3" - 4-9/64" (75 - 105mm) gap.

This extruded aluminum profile offers good resistance to mechanical stress and wear. Use on floor installations.

GADP700



GALDP1000



	H = in	mm	L1 = in	mm	Art.		
Material: Aluminum extruded	9/16	15	3-5/64	78	GADP	700	AN
	9/16	15	4-5/16	110	GALDP	1000	AN
Finish: Natural (AN)							
Length: 13-1/8' (4.00meters)							