

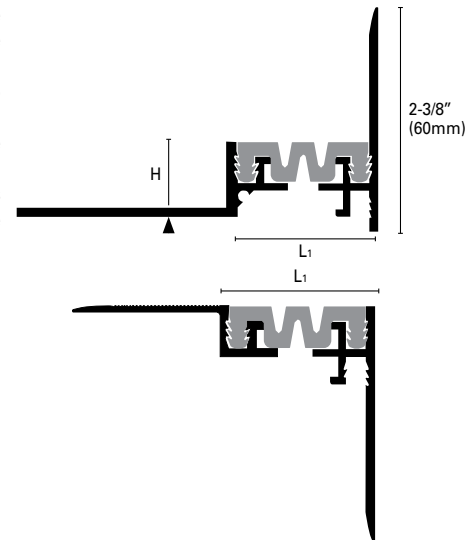

jointec™ P

**JOINTEC P** multipurpose lateral anchoring flange adapts **JOINTEC GE, GM** and **GD** expansion joints into wall-to-floor perimeter joints. The vertical anchoring flange can be installed on the wall facing upwards or downwards hidden in the gap between the wall and the floor.



(GEP 200\* - GDP 400 AN\*)

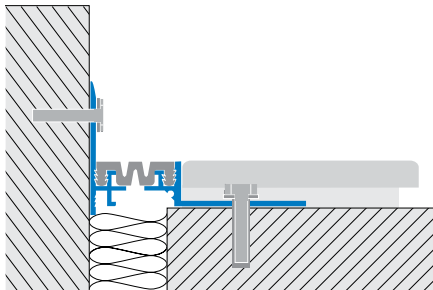

**JOINTEC GEP/GELP Natural Aluminum**

Bridges a 1-9/16" / 2" (40 / 50mm) gap.  
Perimeter version of the JOINTEC GM/GML structural joint series with a 1-15/32" or 1-27/32" (37 or 47mm) - wide rubber insert. Ribbed or smooth versions of the rubber insert are available upon request; see page 179.



**JOINTEC GMP/GMLP Natural Aluminum**

Bridges a 1-9/16" / 2" (40 / 50mm) gap.  
Perimeter version of the JOINTEC GE/GEL structural joint series with a 1-15/32" or 1-27/32" (37 or 47mm) - wide rubber insert. Ribbed or smooth versions of the rubber insert are available upon request; see page 179.



**JOINTEC GDP/GDLP Natural Aluminum**

Bridges a 1-11/16" / 2-3/32" (43 / 53mm) gap.  
Perimeter version of the JOINTEC GD/GDL structural joint series with a 1-15/32" or 1-27/32" (37 or 47mm) - wide rubber insert. Ribbed or smooth versions of the rubber insert are available upon request; see page 179.



	H = in	mm	L1 = in	mm	Art.		
Material: Aluminum extruded	3/4	20	1-9/16	40	GEP	200	AN 51/23*
	2	50	1-9/16	40	GEP	500	AN 51/23*
Finish: Natural (AN)	3/4	20	2	50	GELP	200	AN 51/23*
	2	50	2	50	GELP	500	AN 51/23*
Insert: Resinprene							
Black (P51 - suggested),							
Cement Grey (P23)							
Length: 13-1/8' (4.00meters)							

\*\*S" for the smooth insert version

Material: Aluminum extruded	1-3/8	35	1-9/16	40	GMP	350	AN 51/23*
	2	50	1-9/16	40	GMP	500	AN 51/23*
Finish: Natural (AN)	3	75	1-9/16	40	GMP	750	AN 51/23*
Insert: Resinprene	1-3/8	35	2	50	GMLP	350	AN 51/23*
Black (P51 - suggested),	2	50	2	50	GMLP	500	AN 51/23*
Cement Grey (P23)	3	75	2	50	GMLP	750	AN 51/23*
Length: 9' 10" (3.00meters)							

\*\*S" for the smooth insert version

Material: Aluminum extruded	15/32	12	1-11/16	43	GDP	400	AN 51/23*
	15/32	12	2-3/32	53	GDLP	500	AN 51/23
Finish: Natural (AN)							
Insert: Resinprene							
Black (P51 - suggested),							
Cement Grey (P23)							
Length: 13-1/8' (4.00meters)							

\*\*S" for the smooth insert version