



multidrain MUD

- + Certified Safety
- + Easy to Assemble
- + Simple to Transport
- + Light weight
- + Installation Friendly
- + Performant Drainage
- + Dimensional Stability
- + Economical
- + Sturdy and Resistant
- + Recyclable
- + Long Life
- + Versatile
- + Precious Material
- + Design



MULTIDRAIN is a waterproof modular system for linear drainage of surface water. It can be used in tiled structures, outdoor and indoor.

The system is made of PP (Polypropylene), a light but resistant material, and is composed of 1,48 meter long combinable channels with lateral or central run-off pipes.

The channels internal slope functions as water run-off and is self-cleaning. The system permits even floor tiling with great time saving.

The channel has a pre-felted fabric on its edge, allowing the installation of waterproofing systems (thin bed installation). The grid frames are made of stainless steel AISI 316L.

The system is equipped with run-off pipes, end pieces and grids in stainless steel AISI 304.

Note: On request the grids can be supplied in stainless steel AISI 316L. The channel can be inspected.



CHANNELS:

MUD 1500H

Channel module with high slope.
Length 1,48 ml
To join with another element use MUD 1500M.
For end run-off pipe use MUD 50S.

MUD 1500M

Channel module with medium slope.
Length 1,48 ml
To join with another element use MUD 1500L.
For end run-off pipe use MUD 75S.

MUD 1500L

Channel module with low slope.
Length 1,48 ml
For end linear drain use MUD 75LS.
For horizontal run-off pipe use MUD 90S.

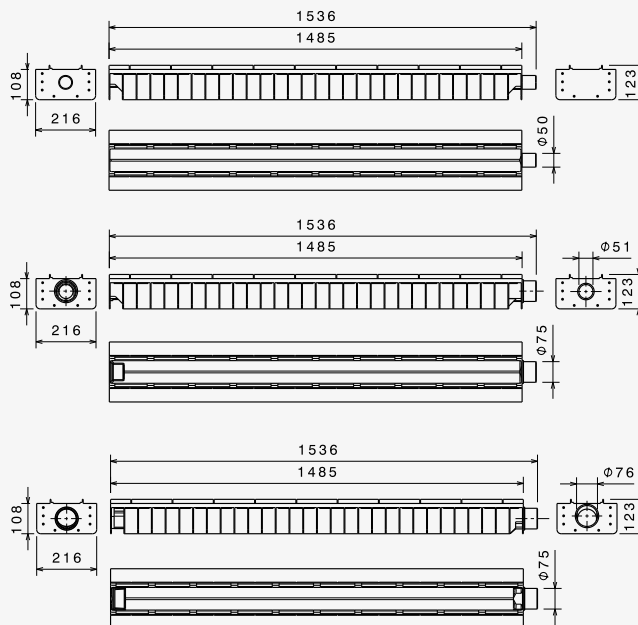

RUN - OFF PIPES AND DRAIN TERMINALS

MUD 50S
Run-off pipe DN 50.

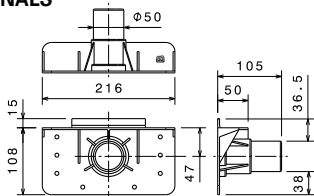

MUD 75HS
Run-off pipe DN 75A.

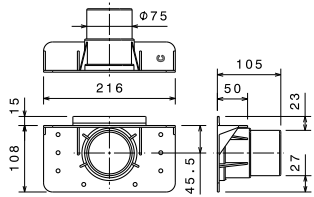

MUD 75LS
Run-off pipe DN 75B.

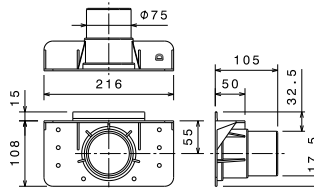

MUD 90S
Run-off pipe
DN 90.

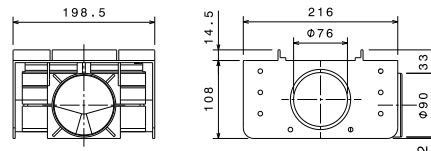

MUD 100T
End blind head.

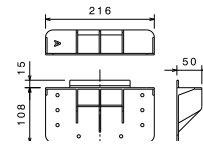

MUD 50C
Closing cap D 50.

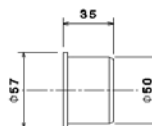

MUD 75C
Closing cap D 75.

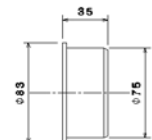

GRATINGS:

MUD 1500GP
Walkable tileable grating.
Length 1485, Stainless Steel AISI 304.

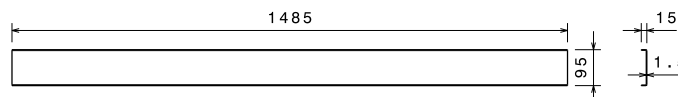

MUD 1500GA
Walkable solid grating.
Length 1485, Brushed stainless steel AISI 304.

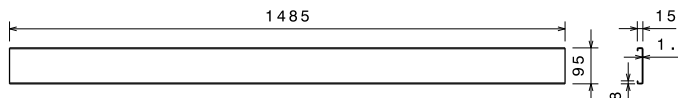

MUD 200GP
Walkable tileable grating.
Length 198.
Stainless Steel AISI 304 brushed.

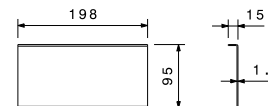

MUD 200GA
Walkable solid grating.
Length 198.
Stainless Steel AISI 304 brushed.

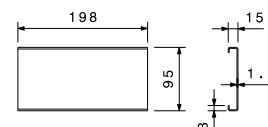

DESCRIPTION	Art.
Channel Body-element - (L= 1,48ml):	MUD 1500H
* Channel Body-element - (L= 1,48ml):	MUD 1500M
** Channel Body-element - (L= 1,48ml):	MUD 1500L
Pedestrian solid grating Stainless Steel AISI 304 (L= 1,48ml)	MUD 1500GP
Pedestrian solid grating Stainless Steel AISI 304 brushed (L= 1,48ml)	MUD 1500GA
Sealing tape H= 120mm Rolls= 20,00ml	FOILTEC tape
*Element following to article. MUD 1500H, **Element following to article. MUD 1500M	

DESCRIPTION	Art.
Tileable pedestrian grating Stainless Steel AISI 304 (L= 0,19ml)	MUD 200GP
Pedestrian solid grating Stainless Steel AISI 304 brushed (L= 0,19ml)	MUD 200GA
Head	MUD 100T
* Run-off pipe DN 50	MUD 50S
** Run-off pipe DN 75 A	MUD 75HS
*** Run-off pipe DN 75 B	MUD 75LS
*** Run-off pipe DN 90	MUD 90S
Closing cap DN 50	MUD 50C
Closing cap DN 75	MUD 75C
Kit composed of: screws, nuts, flat seal, connecting plates, key	MUD FIX
*Suitable to match with Art.MUD 1500H, **Suitable to match with Art. MUD 1500M, ***Suitable to match with Art. MUD 1500L	



Supply of PP watertight modular drainage channel **MULTIDRAIN** with internal slope and a double slit of 8 mm each. Minimum thickness 3 mm, standard height of 12,5 cm.

The channel is equipped with a felted fabric permitting the mechanical coupling at the waterproofing system.

For the waterproofing seal use the strip Foiltec. The tileable grating equipped with a felted fabric which allows the mechanical coupling to the tile.

The channels are fixed to the terminals and to the drain pipes with "male / female" joints that have lip-round seals and are blocked with a system of plates acting externally to the channel flanges, which in turn are connected through another flat silicone seal.

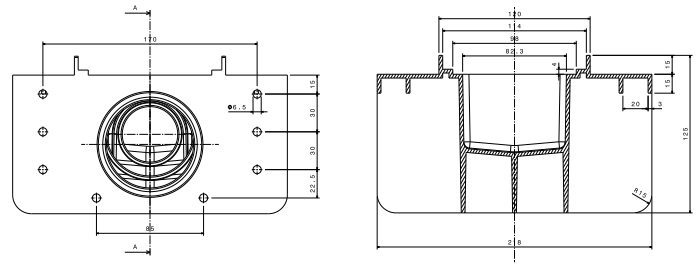

INDICATIONS FOR USE:

- The product and its use are designed for domestic use. For other applications or special conditions check with Profilitec technical department or your specifier.
- The system supports the use of running hot water only for short periods and for temperatures not exceeding 90 ° C.
- Do not use chemical cleaners to remove possible deposits inside the channels.
- The stainless steel surfaces must be maintained and cleaned following standard stainless steel care indications. Do not use cleaning products containing hydrochloric acid and hydrofluoric acid. Do not clean with spatulas or steel wool. The system is suitable for waterproofing with liquid primers or insulation compounds for thin-bed installations.

The system is suitable for thin-bed installations with waterproofing layers made by liquid primers or matting.

- **MULTIDRAIN** system should be scaled according to the total area of drainage.
- The channel must be periodically cleaned to prevent dirt deposit.
- It is made of plastic (PP) and therefore sensitive to certain petrol by-products.
- The system is particularly conceived for the draining of outside areas as in terraces and patios, where the increasing use of large format tiles does not allow the realisation of the traditional 4 slopes converging to the centre.

Multidrain consents the realization of a single slope with a drain-off close to one of the two sides. The system is particularly suitable also for swimming pools, locker rooms and wellness areas.



INSTALLATION GUIDELINES:

EXAMPLE 1:

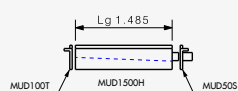

EXAMPLE 3:

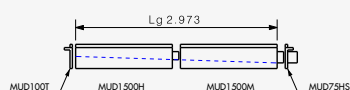

EXAMPLE 5:

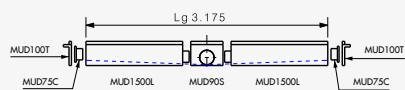

EXAMPLE 7:

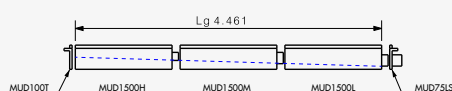

EXAMPLE 2:

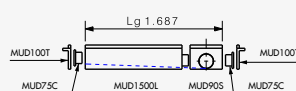

EXAMPLE 4:

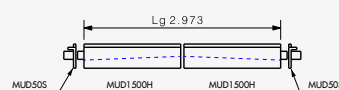

EXAMPLE 6:

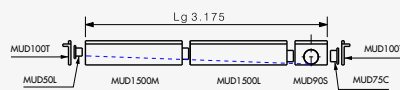

EXAMPLE 8:

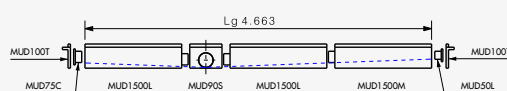

Multidrain allows the realization of a single slope with the outlet close to one of the 2 sides.
The system is also particularly suitable for outdoor, indoor, changing rooms or wellness areas.



ASSEMBLING:

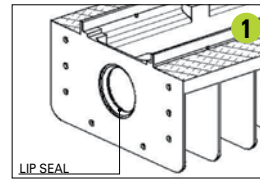

STEP 1
Check that the lip-round seals are placed in their housing at the ends of the channel and are not deformed.

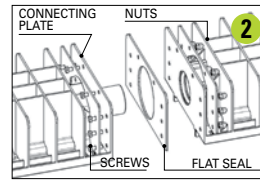

STEP 2
Put the channels upside down on a flat surface to make the installation easier. Lubricate the "male" joint and put the flat seal between the channels. Join the channels at their ends, lining up perfectly the seal with the channels (mounting flange). Place the connecting galvanized iron plates outside the channels contact ends with the seal (mounting flange) and fix the system with the provided screws and nuts (fix using a "criss-cross" sequence). The end caps and the terminals are fixed with the same procedure.

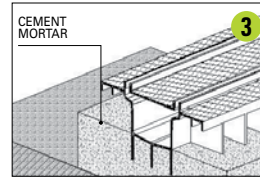

STEP 3
Put the channel into the position of use. For channels of more than 3 metres, more installers are required to avoid twists that would compromise their use. Lay the channel at the project height and make the screed with the grid already mounted.
Note: At the end of this step we recommend to flood the system to check its waterproofing.

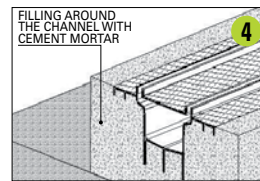

STEP 4
Fill the channel homogeneously with a suitable cement mortar.
Note: This step is to be carried out once the grid has been installed.

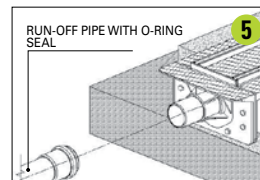

STEP 5
Connect the channel with the drainage system (with the proper size and slope).
Note: Use only pipes with O-ring seal.

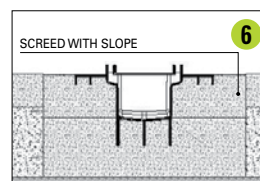

STEP 6
Build the screed to the channel level paying attention not to damage the upper tissue, which is later used for the waterproofing treatment. To protect the tissue use a standard adhesive tape for packaging. Lay the waterproofing in connection with the felted wing. Connect the waterproofing with the channel using Profilitec strip "Foiltec".

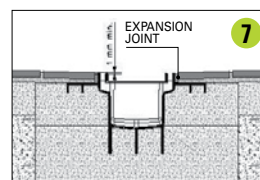

STEP 7
Proceed with tiling, considering that the tiles once installed are 1 mm higher than the stainless steel frame (grating and channel).
Note: The use of an expansion joint is advisable between the channel and the floor. Inside the tileable stainless steel grating we suggest to apply a silicon seal between tiles and stainless steel.

EXAMPLE 9:

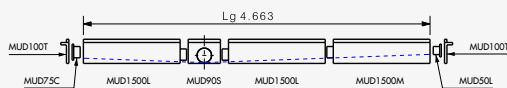

EXAMPLE 11:

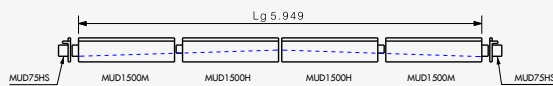

EXAMPLE 13:

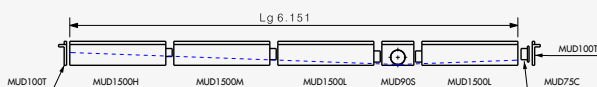

EXAMPLE 15:

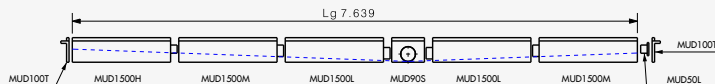

EXAMPLE 17:

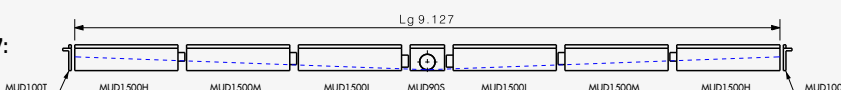

EXAMPLE 10:

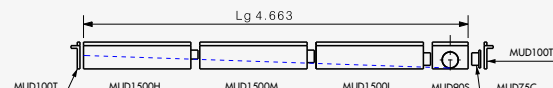

EXAMPLE 12:

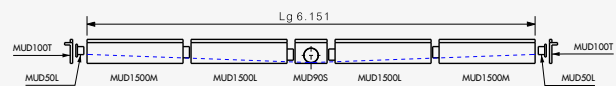

EXAMPLE 14:

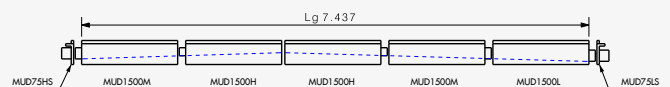

EXAMPLE 16:

