

sanitec IC

Conceived as hygienic wall-to-wall or wall-to-floor transitions, **SANITEC IC** cove-shaped profiles meet hygiene standards in public spaces subject to sanitary inspection, such as hospitals, food processing plants, industrial kitchens and public bathrooms. Ideal for retrofit applications in public building renovations. The slightly rounded edges seal the profile onto the surface. Use our adhesive for on-site installation. The H 2-3/8" (60mm) version also acts as a baseboard.

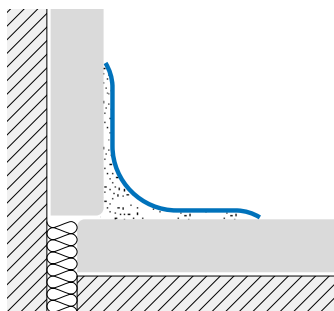
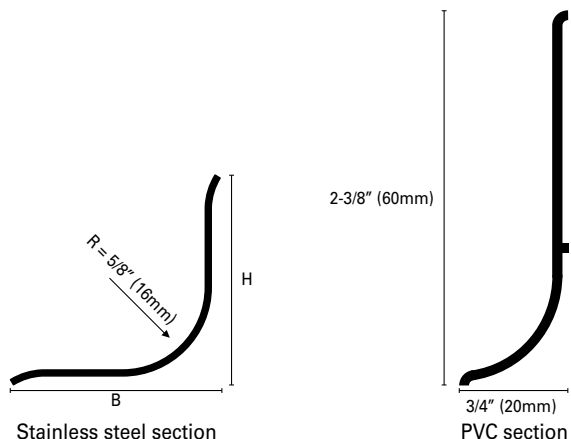

SANITEC IC-ILN Polished Stainless Steel AISI 304 - DIN 1.4301

This stainless steel profile ensures good resistance to mechanical impact and high resistance to corrosion from most diluted chemicals found in laboratories and aggressive detergents present in food processing plants, commercial kitchens, slaughter houses, breweries, public bathrooms and hospitals. Internal (ICI), external (ICE) and three-way (ICT) joint pieces are available.

	BxH = in	mm	Art.		
Material: Stainless steel AISI 304	1x1	25x25	IC	25	IL
Finish: Polished (IL)					
Length: 8'10" (2.70meters)					
Surface with protection film strip					

SANITEC IC 60 P 11 Solid Extruded Synthetic Resin

Extruded as solid synthetic resin, the color is fully embedded in the body of the profile is suitable in diverse design settings. The profile is scratch resistant, tolerant to mechanical impact and most domestic cleaning products.

Material: Resintop	3/4x2-3/8	20x60	IC	60	P11
Color: Pure White					
Length: 8'10" (2.70meters)					