

SANITEC SB-IL stainless steel cove-shaped profiles are easy to clean and designed to meet hygiene standards in public spaces subject to sanitary inspection such as hospitals, food processing plants and public bathrooms. This transition profile is installed on site; the wall and floor coverings are then laid flush onto the lip on the profile.

sanitec SB-IL

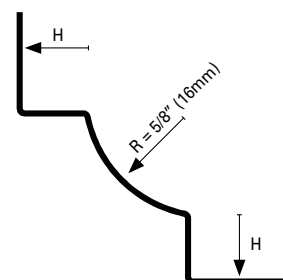

(SB 80*)

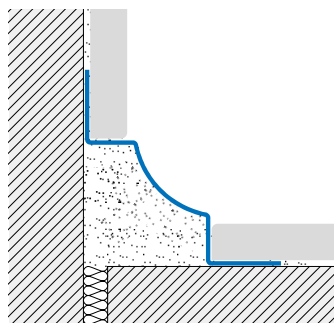

SANITEC SB-IL Polished Stainless Steel AISI 304 - DIN 1.4301

This stainless steel profile ensures good resistance to mechanical resistance and high resistance to corrosion from most diluted chemicals found in laboratories and aggressive detergents present in food processing plants, commercial kitchens, slaughter houses, breweries, public bathrooms and hospitals. It can be used to transition wall and floor coverings with 5/16" to 1/2" (8 to 12.5mm) tile thicknesses. Internal (SBI*), external (SBE*) and three-way (SBE*) joint pieces are available to elegantly detail corner intersections.

For a minimalist and elegant design, **SANITEC SB-IL** cove-shaped profiles can be cut at a 45° angle and used in conjunction with **SQUAREJOLLY SJ** wall profiles.



	H = in	mm	Art.		
Material:	5/16	8	SB	80	IL
Stainless steel AISI 304	3/8	10	SB	100	IL
Finish: Polished (IL)	1/2	12.5	SB	125	IL
Length: 8'10" (2.70meters)					
Surface with protection film strip					

Material:		SBI		ILSET 2
Stainless steel AISI 304		SBE		ILSET 2
Finish: Polished (IL)		SBT		ILSET 2
Junction:				
internal (SBI *)				
External (SBE *)				
end- cap (SBT *)				