

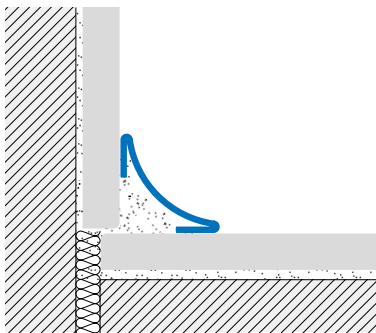

SANITEC SB 15-IL stainless steel cove-shaped profiles are easy to clean and designed to meet hygiene standards in public spaces subject to sanitary inspection, such as hospitals, food processing plants and public bathrooms. To be installed on-site after tile laying.

sanitec SB15-IL

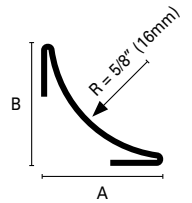

SANITEC SB15-IL Stainless Steel AISI 304 - DIN 1.4301

This stainless steel internal cove-shaped profile ensures good resistance to mechanical impact and high resistance to corrosion from most diluted chemicals found in laboratories and aggressive detergents present in food processing plants, commercial kitchens, slaughter houses, breweries, public bathrooms and hospitals.

	AxB = in	mm	Art.		
Material: Stainless steel AISI 304	9/16	15x15	SB	15	IL
Finish: Polished (IL)					
Length: 8'10" (2.70meters)					
Surface with protection film strip					

Note: end-caps not available