

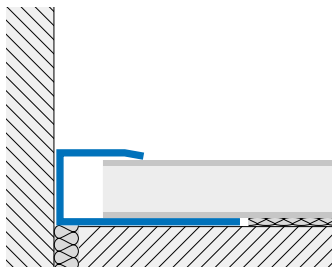

woodtec LT

The **WOODTEC LT** profiles are specifically designed for finishing the perimeter of floating wood floors, particularly when they transition to another floor type at the same elevation or abut a vertical surface. While acting as an expansion joint, they also allow floor edge finishing without baseboards. This profile is also suitable along sliding door tracks and as entrance mat framing. Installed with flathead screws.

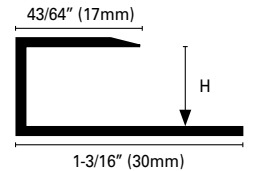

WOODTEC LT-A*N Anodized Aluminum

This profile is available in three finishes: silver (AS), gold (AO), bronze (AB). Due to its chromatic variations, it lends itself to most flooring of varying texture and color. It is highly resistant to oxidation and less resistant to mechanical impact. Brass profiles are recommended for high traffic areas.

	H = in	mm		Art.	
Material:	9/32	7	LT	70	A*N
Extruded Anodized Aluminum	11/32	9	LT	90	A*N
Finish*: Silver (AS), Gold (AO), Bronze (AB)	3/8	10	LT	100	A*N
	33/64	13	LT	130	A*N
Length: 8'10" (2.70meters)	9/16	15	LT	150	A*N

WOODTEC LT-OLN Polished Brass

Due to the intrinsic qualities of the material, this brass profile guarantees resistance to chemical and mechanical impact and is suitable for elegant interior detailing.

Material:	3/8	10	LT	100	OLN
Laminated Brass	9/16	15	LT	150	OLN
Finish: Polished (OLN)	7/8	22	LT	220	OLN
Length: 8'10" (2.70meters)					

WOODTEC LT-ILN Polished Stainless Steel

Offering excellent resistance to mechanical impact, this profile is ideal for industrial and commercial heavy-traffic areas.

Material:	3/8	10	LT	100	ILN
Stainless Steel	9/16	15	LT	150	ILN
Finish: Polished (ILN)	7/8	22	LT	220	ILN
Length: 8'10" (2.70meters)					

WOODTEC LT 90*N Wood Laminated Aluminum

These profiles are designed to join different floor types with a change in elevation ranging from 19/64" to 11/32" (7.5 to 9mm). Available in melamine laminated aluminum, they are available in 8 different finishes. The smoothly-embossed melamine is resistant to abrasion, easy to clean and blends easily with existing floors.

	Finish		Art.	
Material:	Bleached	LT	90	RSN
Extruded Aluminum Laminate cov.	Maple	LT	90	ACN
	Beechwood	LT	90	FAN
Length: 8'10" (2.70meters)	Oak	LT	90	RON
	Cherry	LT	90	CIN
Finish*: 8 wood finish	Light walnut	LT	90	NCN
	Dark walnut	LT	90	NSN
Height: 11/32" (9mm)	Wengé	LT	90	WEN