

PLANO PS

PRODUCT DESCRIPTION



PS Plano baseboard is an aluminum baseboard offered in two heights and in both Powder Coated and anodized finishes and suitable for plasterboard applications directly in walls. The profile, which has multiple installation heights and slab thickness, is easy to apply through the use of special adhesives with FIXXTEC or by fixing with screws. The innovative geometry makes it suitable for applications where some space is required as a perimeter joint but minimizing the curvature at the bottom to keep the appearance clean, in addition, the front allows for an eventual placement of LED strips, should they be required by the designer.

TECHNICAL FEATURES

Length: 2,70 metres

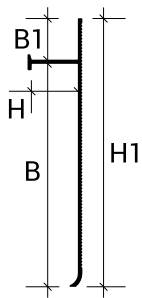

Aluminum
 $B1 = 13 \text{ mm}$
 $H1 = B1 + B + 1,3 \text{ mm}$

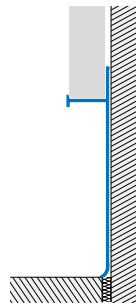

plano >> PS Profile for drywall in Anodized Aluminum			
Cod.	HxB mm	Finish	pcs
PS700/13AS270	13x70	AS - Silver	10**
PS1000/13AS270	13x100	AS - Silver	10**
PS700/15AS270	15x70	AS - Silver	10**
PS1000/15AS270	15x100	AS - Silver	10**

plano >> PS Profile for drywall in Powder Coated Aluminum			
Cod.	HxB mm	Finish	pcs
PS700/13AM11270	13x70	AM11 - Matt White	10**
PS1000/13AM11270	13x100	AM11 - Matt White	10**
PS700/15AM11270	15x70	AM11 - Matt White	10**
PS1000/15AM11270	15x100	AM11 - Matt White	10**
PS700/13A54270	13x70	A54 - Matt Black	10**
PS1000/13A54270	13x100	A54 - Matt Black	10**
PS700/15A54270	15x70	A54 - Matt Black	10**
PS1000/15A54270	15x100	A54 - Matt Black	10**

MATERIAL DESCRIPTION

Aluminum

A primary alloy suitable for complex extrusions, it has high strength and an excellent surface finish in its natural state that is excellently suited for subsequent finishing processes.

The anodic oxidation process works against corrosion generated by atmospheric agents not combined with galvanic processes. The profiles are treated with preventive processes that make them uniformly opaque, then they are colored by electro-chemical oxidation process with thickness up to 20 microns.

The coating process consists of a pre-treatment based on chromium phosphate, an electrostatic coating based on polyester powders with high U.V. and weathering resistance characteristics. The coating thickness involves the entire surface of the profile with an average thickness of ca 60 microns, a hot cross-linking polymerization process is also carried out to ensure maximum chemical-mechanical resistance.

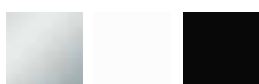

AS AM11 A54

APPLICATION AND INSTALLATION

Cut the baseboard to the desired length.

Clean the supporting wall of residual oil, grease and general dirt.

Apply FIXXTEC multipurpose sealant to the top and bottom parts of the profile.

Press the profile against the wall by exerting adequate pressure. Then install the plasterboard wall by resting the slabs on top of the horizontal support faceplate and securing them with screws.

In case of an uneven, difficult-to-clean wall or where there is no wall but only a supporting frame available, fix the skirting board with screws by securing it from the top that will be covered by the plasterboard sheet. The faceplate can shield from view the installation of a possible LED strip (not provided).

CLEANING AND MAINTENANCE

For cleaning, do not use abrasive or acid-based cleaners (e.g., hydrochloric acid). The profile does not require special care or maintenance. Carry out thorough cleaning of the profiles immediately after laying to prevent any products used during laying from damaging the surface layers.

SPECIFICATION GUIDES

Supply and installation of the profile in _____ (material), with finish _____ (see material description section) of characteristic size _____mm, equipped with a curve acting as a perimeter joint cover, a shielding faceplate for a possible LED strip and a rear flap for wall fastening using screws.

Family type _____ by the company Profilitec to be used as a floor sealing profile, perimeter expansion joint protection, and wall finish with plasterboard sheets, to be supplied and installed in accordance with the methods and fields of application specified by the manufacturer.

Profile length: 2700mm

Profile Code: _____

Material: _____ €/m

Laying: _____ €/m

Total price: _____ €/m

TECHNICAL INFORMATION

If you have any further questions, please feel free to contact our Technical Department at: profilitec@profilitec.com

* 10% increase for quantities lower than 20

** 10% increase for quantities lower than those indicated

Profilitec S.p.A.

Via Scotte, 3 - 36033 Isola Vicentina (Vicenza), ITALY

Tel: +39 0444 268311

e-mail: profilitec@profilitec.com

Profilitec Corp.

e-mail: customerservice@profilitec.com

Profilitec Ibérica, S.L.U.

e-mail: iberica@profilitec.com

