

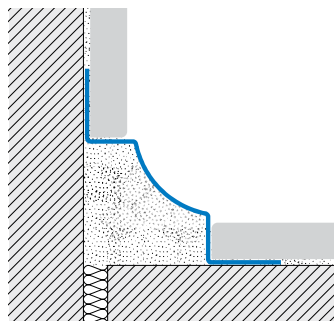

SANITEC SB is a stainless steel internal cove profile designed to ensure hygienic functions in all areas subject to sanitary inspection. Thanks to its internal curvature and to the characteristics of the used material, it perfectly meets the hygiene requirements and applications expected in hospitals, public and food processing plants, public toilets and other required areas. This profile is to be installed during laying, providing a neat finish at the same level with the adjacent tiled surfaces.

sanitec™ SB

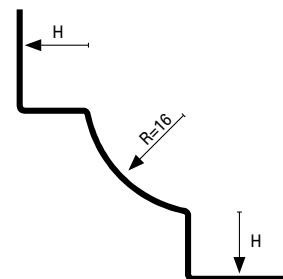

SANITEC SB Stainless Steel AISI 304 - DIN 1.4301 Polished or sanded

Internal cove profile to be installed while tiling between two tiled walls. Stainless steel AISI 304 standard ensures high resistance against corrosion, being then ideal for food processing plants, sanitary, chemical and hospital sectors. Very good mechanical resistance.

Possibility of customizing the profile height for the wall or the floor from 8 to 12,5 mm. Junction pieces available: internal (SBI*), external (SBE*) and three-way (SBT*) to finish the corners in a neat and elegant way.

Combining an SJ profile with the corner pieces it is possible to get a three-way finish by using in vertical a more minimalist and aesthetically effective solution.



	H=mm		Art.	
Material:	8	SB	80	IL
Stainless Steel AISI 304	10	SB	100	IL
Finitura: Polished (IL), Sanded (IX)	12,5	SB	125	IL
	10	SB	100	IX
Length: 2,70 metres				
Surface with protection film strip				

Material:		SBI		ILSET 2
Stainless Steel AISI 304		SBE		ILSET 2
Finitura: Polished (IL), Sanded (IX)		SBT		ILSET 2
		SBI		IXSET 2
Junction:		SBE		IXSET 2
internal (SBI *)		SBT		IXSET 2
External (SBE *)				
end- cap (SBT *)				